

Recommendations for the Installation of PROFAB ACCESS 2000 Series Access Panels



Contents

Handling, storage & protection	P3
Handling	P3
Storage	P3
Protection	P3
Before You Start	P3
Opening	P3
Panel Finishes	 P4
Installation	 P4
Adjusting Door Sizes	
Apertures	P4
Frame Packer Materials Requirements	P5
Fixings	P5
Tools & Components Required	P5
Operation	P5
Key Features	P6
Contact Details	 P7

Handling, storage & protection

Handling

- Profab Access Ltd Access Panels, Riser Doors and Doorset's are a high quality product and therefore require an appropriate level of protection on site; we recommend the packaging should not be removed until immediately before the doorset's are ready to be installed.
- Our products can be heavy and difficult to manoeuvre, so please take extra care to avoid damage to the product and prevent injury to site personnel, always work in accordance with sites manual handling policy.
- Our products are designed for forklift truck off-loading and will be supplied wrapped in stacks for ease of distribution.

Storage

The correct storage conditions of Profab Access Ltd products is essential to ensure the product performs and appears as specified. Storage and protection of the products on site is the responsibility of the contractor. Profab Access Ltd products should be stored close to the final installation area or in a location with limited access and traffic.

DO NOT

- Store on panel/frame edge.
- Store directly on the floor.
- Store near heaters.
- Stack product lent against walls.
- Stock product over 1 metre high.
- Store other product on top of the stored panels.
- Restack panels after delivery without using the same material or method to that used while the products were being transported.

Protection

2000 Series access panels are supplied boxed which will offer transport protecting only. Dependent on site conditions it may be required to add a Protek type of protection to the panel face.

It is the responsibility of the contractor's to assess the level of protection required for the panel and provide it. When applying Protek or applying other types of protection a low tack adhesive tape should be used, do not use any form of packing tape or duck types of tape as this may damage the panel.

Low tack tape can be purchased from Profab Access Ltd.

Before you start

Opening

- Make sure that you have the correct panel/doorset in relation to the opening in which it is going to be installed; each product has a unique reference located on the label (Door Number), which links with the contract drawings and schedules.

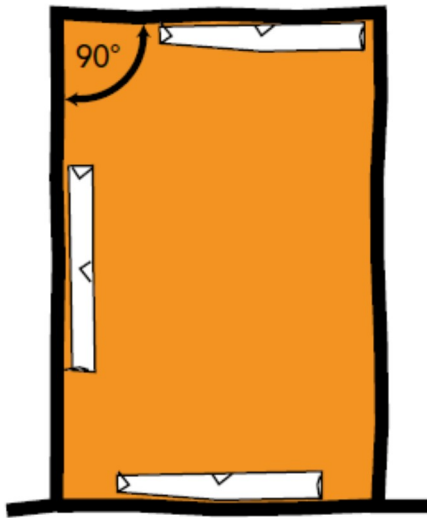

- Check the structural opening is plumb and level before you start installation. Our product is designed to allow for an opening to be no greater than 5mm out of square.
- Before removing the packaging check that the overall dimensions of the panel will fit the opening it is intended for, if correct remove the transport packaging and take care to retain any loose items.
- The 2000 series is good for retrofitting after urgent access is required.



Panel Finishes

Finish is self-colour white, lightly textured for painting or wall papering on-site if required.

If in doubt or if there are any questions please contact a member of the Profab Team

Installation

Installation

Correct sized apertures can be roughly cut through the ceiling or wall membrane. Dust and debris should be cleared from the surfaces before the panel is bonded in position using a silicone adhesive. Due to the lightweight nature of the panel, most membranes will support the panel weight without any further support. Typical fixing details are shown below.

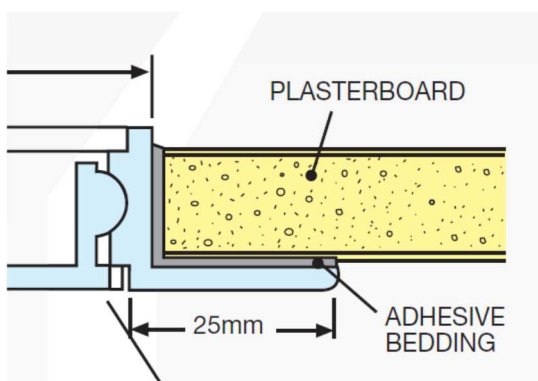

Adjusting panel sizes

All of our panels are made to measure and cannot be cut down / adjusted, it is recommended that the structural openings are measure prior to the panels being manufactured.

Apertures

No site cutting of any type of aperture is permitted.

Frame Packer Material Requirements

No frame packers are required.

Fixings

Panels are bonded in position using a silicone adhesive

Tools & Components Required

- Mastic & mastic gun.
- Basic Hand Tools

Operation

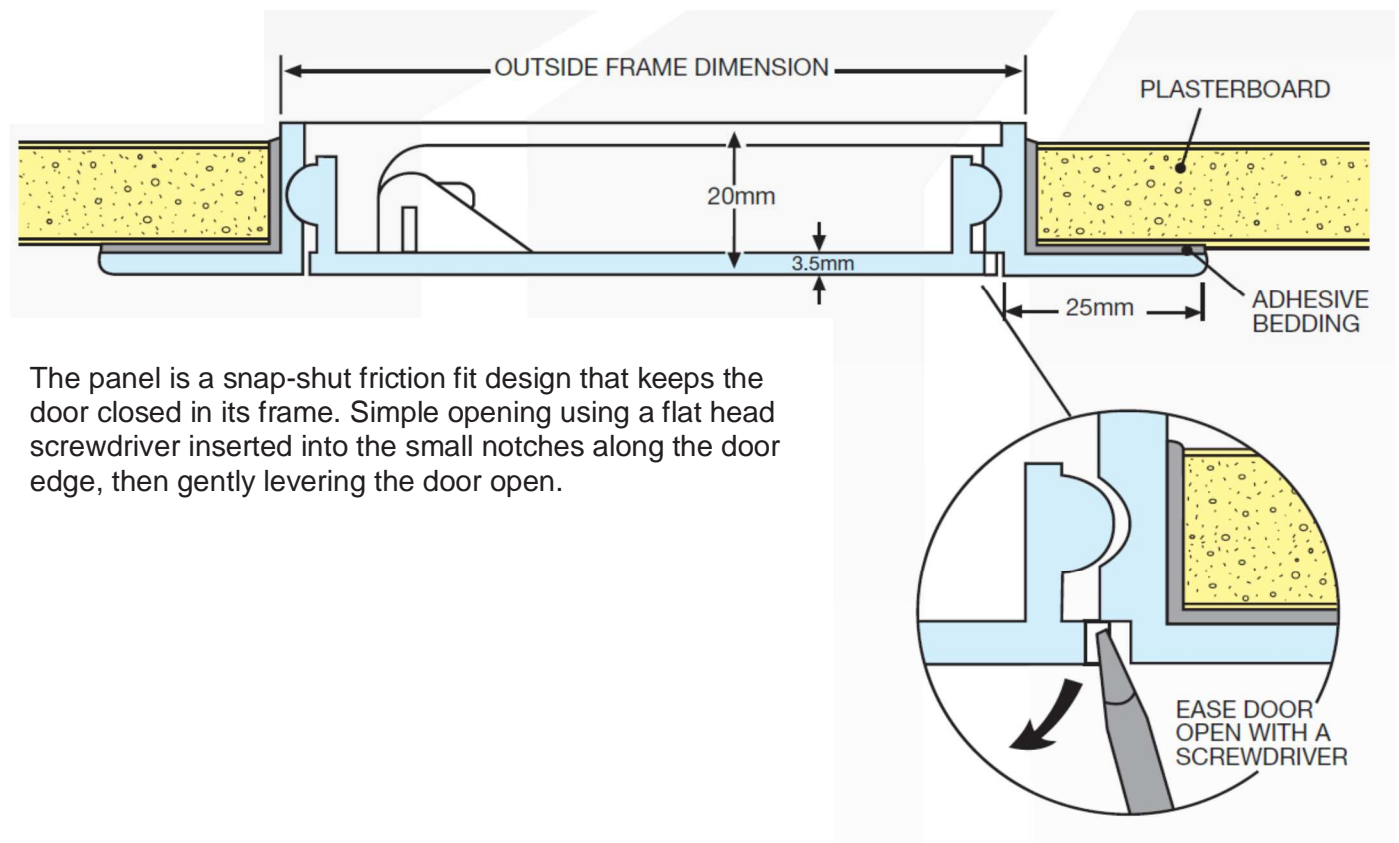

The panel is a snap-shut friction fit design that keeps the door closed in its frame. Simple opening using a flat head screwdriver inserted into the small notches along the door edge, then gently levering the door open.

Key Features

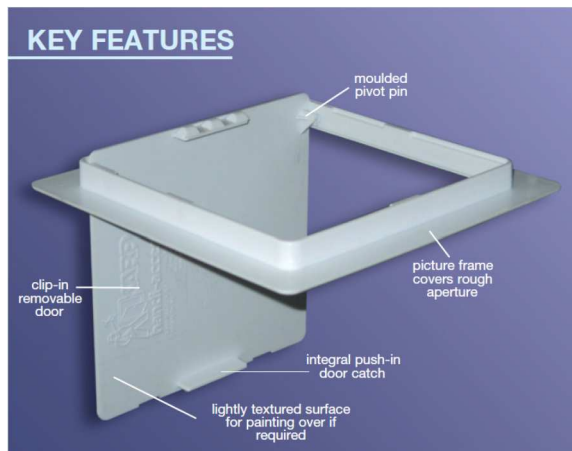

Door/Frame: The door and frame are manufactured separately from injection moulded high-impact white styrene plastic to a nominal material thickness of 3.5mm. The door is easily removable from the frame requiring no tools. A simple pivot is moulded into the door rear. The door is kept closed by concealed, integral location lugs. No locking facility is available on this range. The door can easily be opened with a standard flat-head screwdriver.

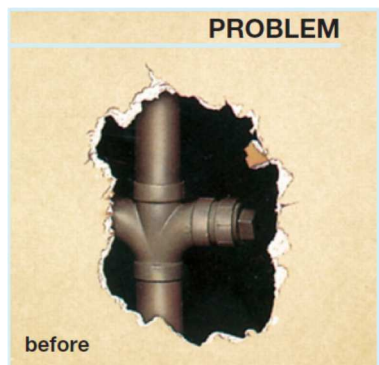

The 2000 series can be used in a multitude of situations where access to valves, plumbing and switches etc, requires simple un-hindered access without the need for security. It is ideally suited to domestic/residential situations, either as a new-build or retro-fit following remedial work.

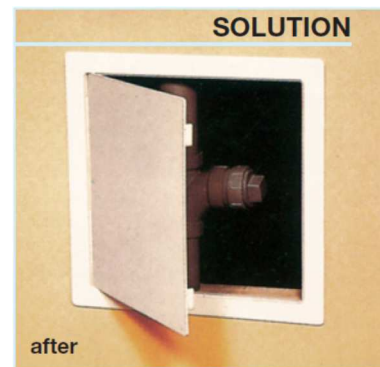

Regular access point in mineral fibre suspended ceiling. Essential if tile hold-down clips are being used.

Contact Details

Sales / Technical Enquiries

 +44 (0) 1827 719 051

 technical@profabaccess.com

Connect With Us

 profabaccesspanels.com

 [profabaccesspanels](https://www.facebook.com/profabaccesspanels)

 [@accesspanels](https://twitter.com/accesspanels)

 [youtube.com](https://www.youtube.com) (search Profab Access Ltd)

